

# Brush Strip Seals

## Nylon Filament



### RP74F



A nylon brush strip seal that is ideal for sliding or double acting doors. Can also be used for the stiles of tilt-up doors. The brush houses a unique medium temperature fin, which is effective in the sealing of medium temperature smoke, noise and weather.

Used in conjunction with Raven threshold plates

**Location:** Frames or bottoms of single, double, sliding and double acting doors as well as stiles of tilt up doors.

**Min/Max Gap:** Up to 13mm (user determined).

**Finish:** Satin clear (silver), bronze anodised aluminium (15µm) or paint at extra cost (page 7).

**Fixing:** Self adhesive or can be screw fixed. *Note: Contact surface must be clean, smooth and if painted, well cured.*

**Seal:** Black fine, dense, UV stabilised nylon filaments with a medium temperature smoke barrier fin.

**Sizes:** Available in stock lengths.

#### Approvals

**Energy NCC Pt. 3.12.3.3 & J3.4.**

**BAL SFZ** when used on a garage in accordance with AS 3959.

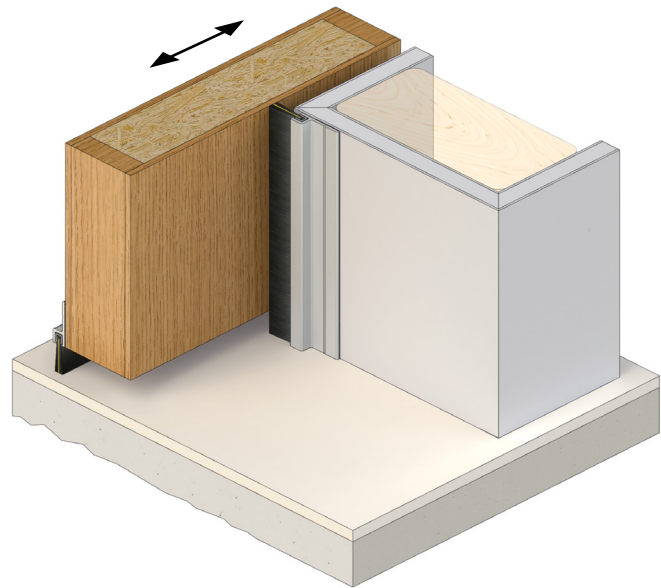
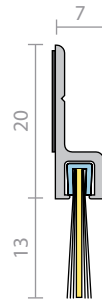

### RP75



A nylon brush strip seal that is ideal for sliding or double acting doors. Can also be used for the stiles of tilt-up doors.

Used in conjunction with Raven threshold plates

**Location:** Frames or bottoms of single, double, sliding and double acting doors as well as stiles of tilt up doors.

**Min/Max Gap:** Up to 19mm (user determined).

**Finish:** Satin clear (silver), bronze anodised aluminium (15µm) or paint at extra cost (page 7).

**Fixing:** Self adhesive or can be screw fixed. *Note: Contact surface must be clean, smooth and if painted, well cured.*

**Seal:** Black fine, dense, UV stabilised nylon filaments.

**Sizes:** Available in stock lengths.

#### Approvals

**Energy NCC Pt. 3.12.3.3 & J3.4.**

**BAL SFZ** when used on a garage in accordance with AS 3959.

