

- (1) Latch unit
- (2) Sleeve for 1"(25mm) dia Hole
- (3) Screws, Phillips flat HD
- (4) Inside lever
- (5) Rose scalp
- (6) Machine screws, Phillips oval HD
- (7) Inside rose
- (8) Mounting screws, Phillips flat HD
- (9) Inside support plate
- (10) Lock body
- (11) Outside support plate(threaded) for 1-3/8"(35mm) thk door.
- (12) Outside rose
- (13) Cylinder

- (14) Plastic retainer
- (15) Push pin(provided)
- (16) Outside lever
- (17) Key
- (18) Strike
- (19) Strike box(optional)
- (20) Thru-Bolt
- (21) Cup

(A) WITH REMOVABLE THRU-BOLTS

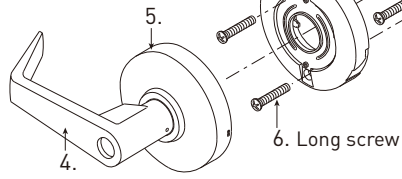

Caution: Installing this unit with thru-bolts removed may cause lever sagging in future operation.

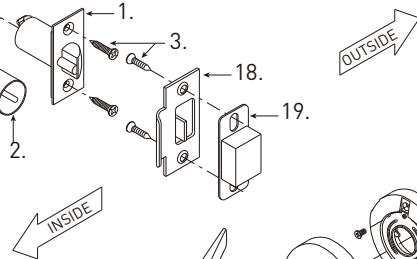
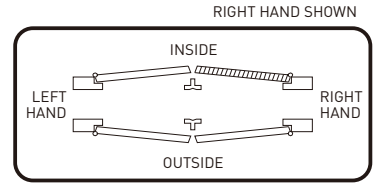

This lock is pre-set at factory for 1-3/4"(45mm) door thickness.

(B) WITHOUT THRU-BOLTS

1. DOOR PREPARATION

- A. Check lock for proper backset before drilling.
- B. Place paper template(supplied) on door and mark for holes. Drill the cross-bore hole, and 2 small holes of 5/16"(8mm) for thru-bolt, and then the latch hole.
- C. Mortise latch unit front 5/32"(4mm) deep into door edge to dimensions shown in Fig 2.
- D. Insert latch unit(1) with sleeve(2) if hole is 1"(25mm) dia., or without sleeve into 7/8"(22mm) dia. Hole. Make certain that latch bolt bevel faces direction of closing door.
- E. Drill two 1/8"(3mm) dia. holes and secure latch unit with screws(3) supplied.

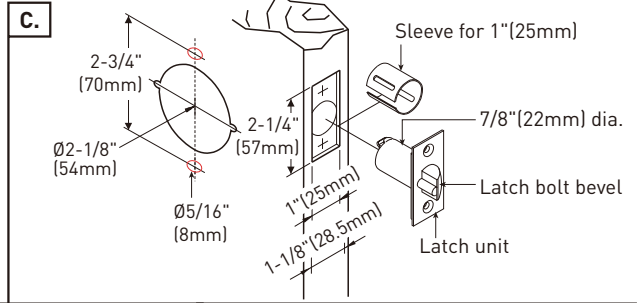
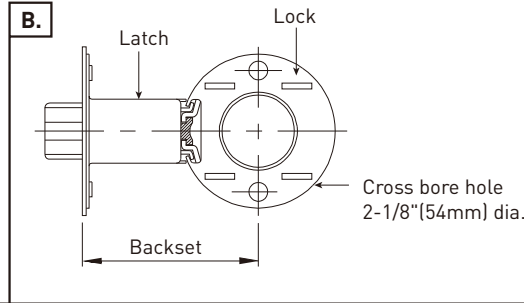
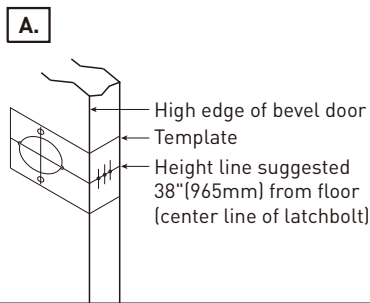

2. TO MAKE ADJUSTMENTS FOR DOOR THICKNESS

- A. The lock can be adjusted for door thickness from 1-3/8"(35mm) to 1-13/16"(46mm).
- B. Remove outside lever by inserting key(17) and turn 45° clockwise. Insert push pin into hole on lever to depress lever catch. Slide the lever(16) from tube.
- C. Remove outside rose(12).
- D. Rotate outside support plate(threaded)(11). Make certain center line of latch unit tail piece in line with door thickness center. (refer to Fig. 3.)

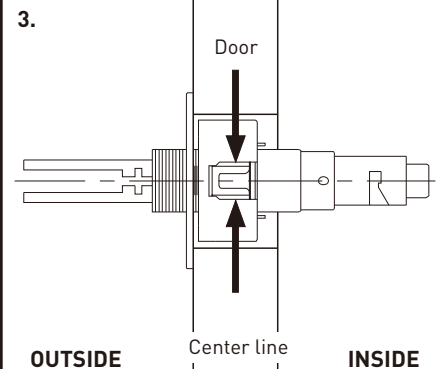
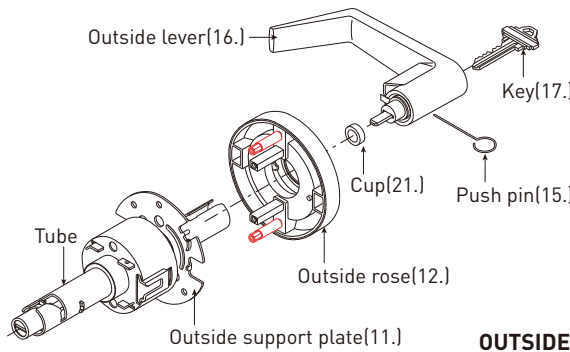

INSTRUCTIONS FOR INSTALLATION OF CYLINDRICAL SERIES LEVERS

4. DISASSEMBLY OF LOCKSET UNIT

- A. To remove inside lever, insert push pin(provided) into hole on lever to depress the lever catch. Slide the lever from the tube. Remove rose scalp by slightly twisting counterclockwise and pull off.
- B. Loosen two thru-bolt screws and remove inside rose.
- C. Loosen two mounting screws and remove inside support plate.

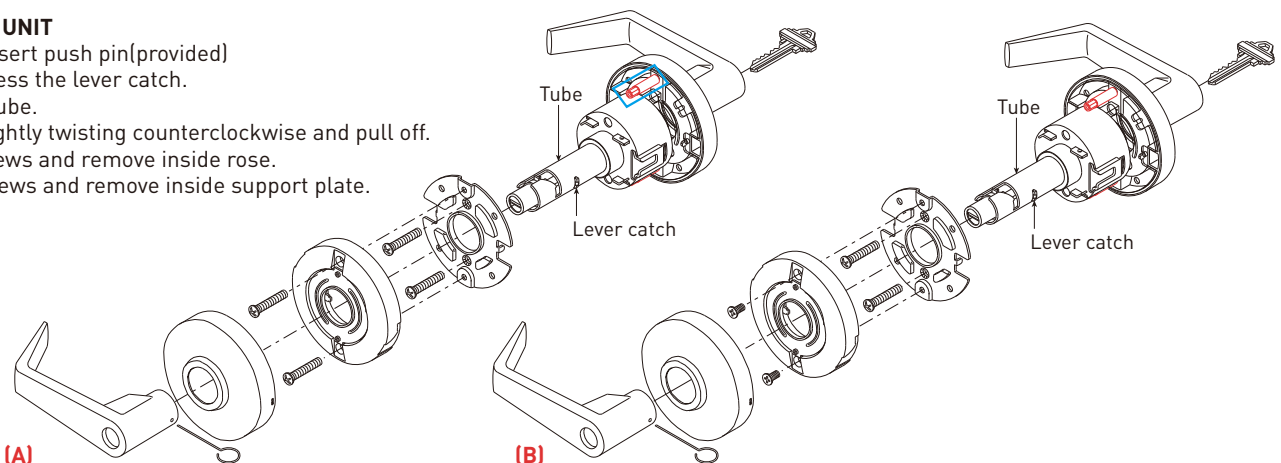

Fit here on door edge.

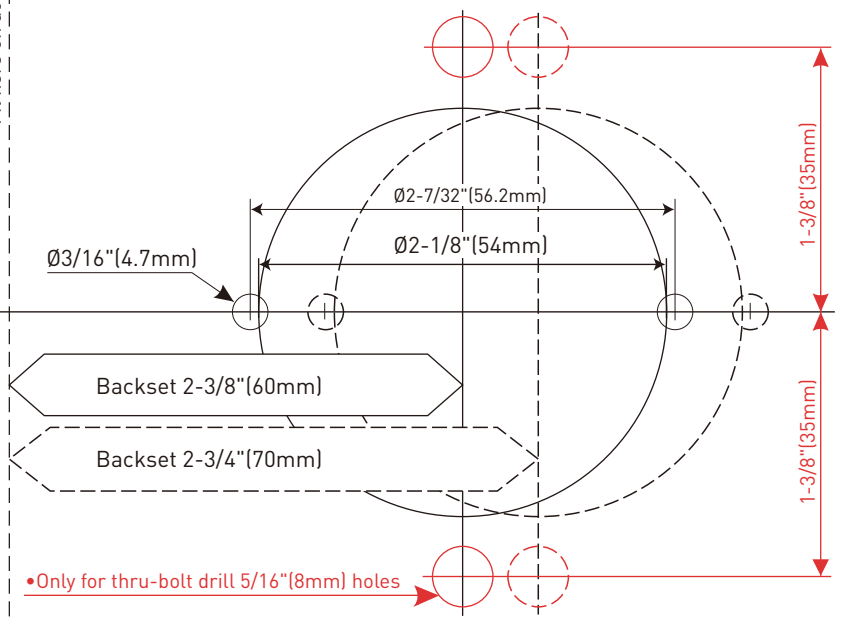
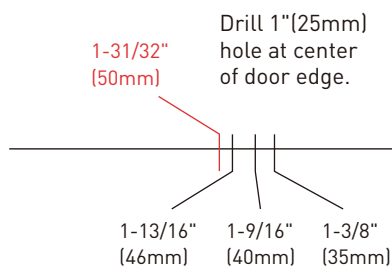

The following requirements should be observed to keep your locks last longer in finish:

1. Do not install locks before doors are painted.
2. To avoid oxidation, refrain from using cleansers or acid chemicals to polish or be in contact with locks.
3. Refrain from using heavy or sharp-edged objects to scrub locks.

5. LOCK BODY ALIGNMENT & CENTERING

The lock body must engage the latch unit(1) prongs as shown. The lock body retractor must engage the latch unit tail piece. Door must be open when installing lockset with guarded latch unit.

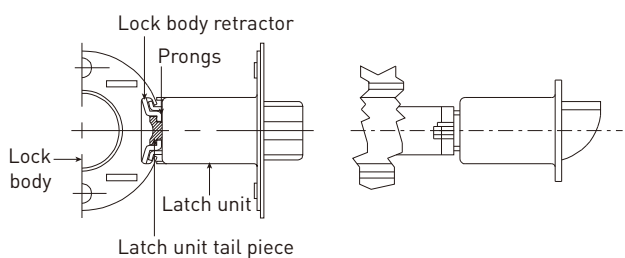

6. INSTALLATION OF LOCK UNIT

(For 50mm THK Doors, please refer to other instructions sheet) Slide lock body into cross-bore hole from outside position with thru-bolt through the two small holes. Have retractor engaged with latch tail piece.

Without thru-bolt, slide lock body into cross-bore hole from outside position. Have retractor engaged with latch tail piece. (See Figure B.)

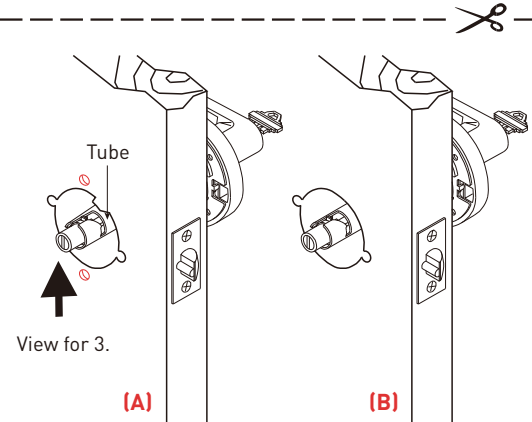

7. SECURING THE LOCKSET UNIT TO DOOR

Place the inside support plate(9). Tighten two mounting screws(8).

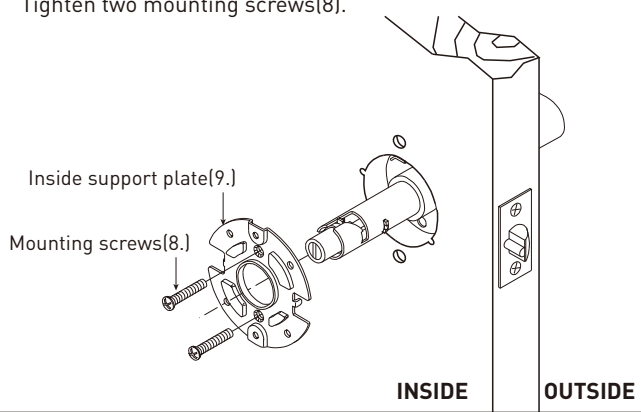

8. ATTACHING INSIDE ROSE

A. Position the inside rose screw holes vertically with longitudinal slot on tube. B-1. Then slide onto tube. Secure inside rose with two thru-bolt screws(6). (A) B-2. Then slide onto tube. Secure inside rose with two short screws(6). (See Figure B)

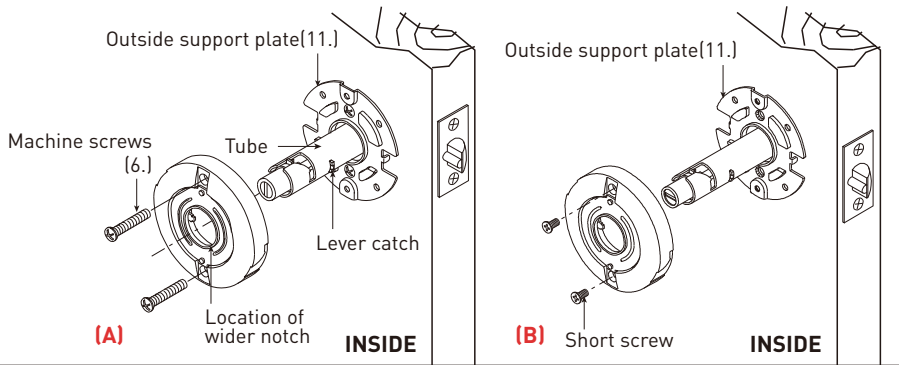

9. INSIDE LEVER INSTALLATION

A. Place rose scalp(5) onto inside rose. B. Slide inside lever(4) onto tube. Make certain lever catch on tube is engaged with lever.

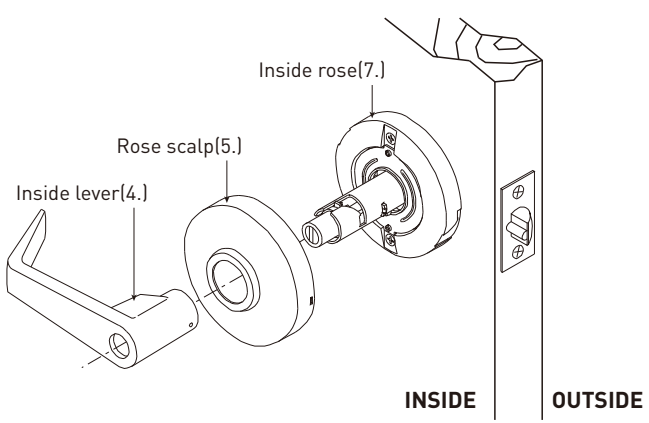

10. INSTALLING STRIKE

When strike box(19) is not used, recess in door jamb must be deep enough to allow latch bolt to extend to its full free length.

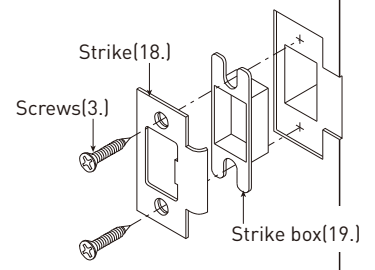

11. CYLINDER REMOVAL

A. Remove outside lever(16) as described in section 4. B. Use push pin(provided) to depress retainer(14), and take out retainer. Then cylinder can be removed. C. When replacing cylinder, secure by pressing retainer till flush with shelf.

