

Brio®

Brio® where ideas unfold



Brio® Single Run

Top hung straight sliding architectural systems
for panels up to 350kg

Brio® where ideas unfold

Watch your adventurous architectural ideas unfold into exciting reality with the Brio range of sliding and folding door hardware.

Brio is passionate about shaping the spaces in which people live, work and play. With subsidiaries in the UK and USA – Brio is recognised by architects worldwide as a leading design and manufacturing company.

Brio's R&D department brings a strong design element to the business, developing and testing ground breaking concepts that continue to be at the forefront of the industry.

So it's no surprise our name Brio translates to Energy, Spirit and Vitality – the core values that drive us to always discover new solutions for our customers.

We are committed to the continuous improvement of quality. That is why Brio, located in Sydney, is certified to Quality Management System AS/NZS ISO 9001:2015.



Single Run 80 and 100

Brio's Single Run 80 and 100 systems are designed for interior and exterior sliding shutters and doors up to 80 and 100kg in weight for residential or light commercial applications. These systems are suitable for single panels sliding to one side or two panels bi-parting in a single run of track. Alternatively, panels can slide parallel to each other to suit almost any configuration.

The compact structural aluminium 100 track can be top-fixed through the track or side fixed using the Brio stainless steel face fixed mounting brackets for single or double track runs. The 100 track profile ensures the wheels cannot disengage and serves to reduce the risk of contamination as debris is less likely to accumulate on the raised rails. The track is available in either mill or 25 micron clear anodised aluminium for improved corrosion performance.

Single Run 80's glass reinforced nylon hanger body with stainless steel fixing plate and hanger bolt ensures long life and high corrosion resistance. Single Run 100's cast alloy hanger body offers improved performance for heavier panels and is also available with stainless steel fixings. Both hangers use 4 wheels with reinforced nylon tyres which are available with a choice of chrome or stainless steel high-speed precision bearings. This combined with the unique 100 track profile offers years of silent, smooth operation and superior rolling performance.

Max panel weight: 80kg

Max panel height: 3000mm

Min panel thickness: 28mm

Application: Interior and exterior sliding timber or aluminium shutters and doors

Max panel weight: 100kg

Max panel height: 3000mm

Min panel thickness: 28mm

Application: Interior and exterior sliding timber or aluminium shutters and doors

Optional Accessories

Soft Close: 100SCL (10-50kg panel)

100SCT (51-100kg panel)

Simultaneous: SIM/2 (Max panel weight 100kg)

The hanger and fixing plate allow simple height adjustment by tightening or loosening the hanger bolt. The hanger plate also features two anti-slip tabs to prevent the door from disengaging from the hanger bolt. A comprehensive range of bottom channels and guides are available to suit a wide range of applications.

Both systems are designed to operate with Brio's soft close device for panels up to 100kg. The neat design allows the device to be housed inside the track ensuring minimum clearances between track and panel are maintained.

(For more information on soft close, refer to page 16)

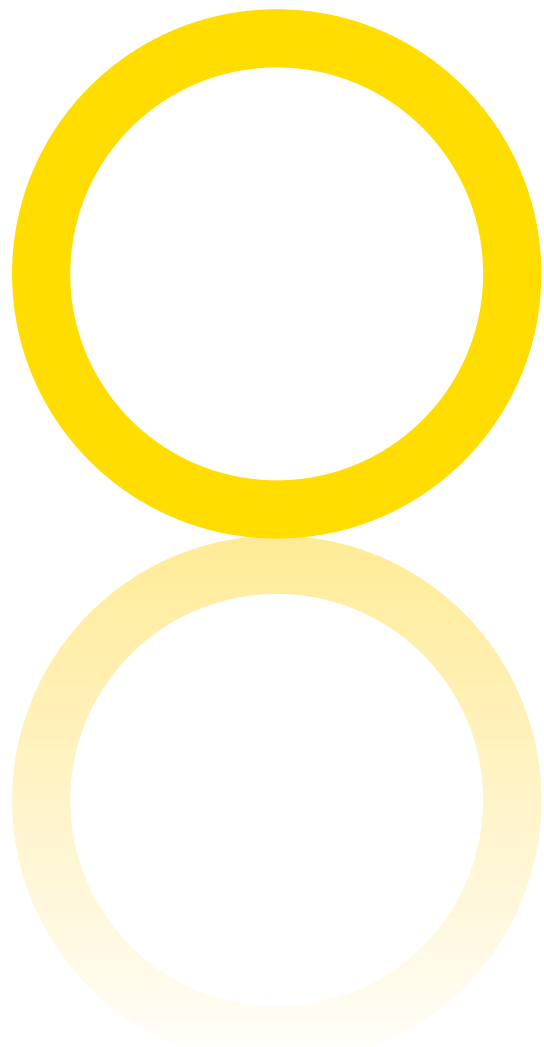



Single Run 100



Single Run 120



Single Run 120

The Brio Single Run 120 system is designed for interior and exterior sliding shutters and doors up to 120kg in residential or light commercial applications. It uses 4 nylon tyred, chrome or stainless steel high-speed precision bearings for smooth operation. The 120 series' cast stainless steel hangers make it a durable solution for high traffic applications with impressive corrosion resistance.

There are several dedicated hangers to suit a wide range of applications and door constructions, such as timber, aluminium or MDF. Each hanger has been designed for simple installation and ease of adjustment. A comprehensive range of bottom channels and guides are also available.

The system is suitable for a single panel slid to one side, or two panels bi-parting in a single run of track. The 120A track can be soffit-fixed through the top, or side-fixed using Brio stainless steel face-fixed mounting brackets for single or double track runs. Fascia option is also available for a clean uninterrupted look.

Our 120R track is suitable for internal applications for easy integration with ceiling tiles. 120R and 120A tracks are both available in mill and 25 micron clear anodised for improved corrosion performance.

Max panel weight: 120kg

Max panel height: 3000mm

Min panel thickness: 19mm

Application: Interior and exterior sliding timber or aluminium shutters and doors

Optional Accessories

Simultaneous: SIM/2 (Max panel weight 100kg)

Telescopic: TEL/2 (Max panel weight 120kg)

TEL/3 (Max panel weight 100kg)

Fascia: 123



Single Run 180

Designed by MAKE Architecture



Single Run 350

Joinery by Nicco Joinery

Single Run 180

The Brio Single Run 180 is arguably the most versatile of all the Brio straight sliding systems. The 180kg panel capacity can accommodate large panels, for example, an aluminium framed panel 2.5m x 2.5m with 10mm thick glass can slide on a single track or parallel to another. Single Run 180 is suited to both internal and external residential, commercial and light industrial applications.

As with all the straight sliding architectural systems the preferred choice of material is stainless steel. Cast marine grade 316 stainless steel is used in the hanger body to minimise joints and screws for the ultimate in strength. Only with cast technology is it possible to form complex shapes and introduce safety features such as anti-slip. Should a locking nut become loose using Brio hardware the panel cannot simply slide off its hanger.

Stainless steel comes as standard for all Brio Single Run Architectural Systems. The only optional upgrade are the bearings. There is a choice of chrome steel bearings or full stainless steel for those more exposed applications.

The 180's versatility comes into play with hangers to suit heavy timber, aluminium and metal doors with options for corner, top fixing or bolting through angles and box sections. The track can be soffit-fixed through the top, or side-fixed using Brio cast stainless steel face-fixed mounting brackets for single or double track runs.

The 180A track is available in either mill or 25 micron clear anodised aluminium for improved corrosion performance. Fascia option is also available for a clean uninterrupted look. A comprehensive range of bottom channels and guides are available to suit a wide range of applications.

Max panel weight: 180kg

Max panel height: 3000mm

Min panel thickness: 35mm

Application: Interior and exterior sliding timber, metal or aluminium shutters and doors

Optional Accessories

Simultaneous: SIM/2 (Max panel weight 100kg)

Telescopic: TEL/2 (Max panel weight 120kg)
TEL/3 (Max panel weight 100kg)

Fascia: 183

Single Run 350

Structural aluminium track with 3mm wall thickness enables Brio architectural systems to support panels weighing up to 350kg. Brio Single Run 350 is ideally suited to large openings in residential, commercial and industrial interior or exterior applications.

To accommodate these higher loads, the wheels used in Single Run 350 increase in size. Like all Brio Single Run systems, the combination of precision bearings, nylon tyred wheels and our unique track profiles offer quiet finger-tip control.

Brio Single Run is designed to be discrete which is why our square track is ideally shaped for recessing into the ceiling line. Two parallel track seal grooves locate brush seals that hide the hanger bolts and brackets, while providing sound reduction. The track can be soffit-fixed through the top or side-fixed using Brio stainless steel face-fixed mounting brackets for single or double track runs.

The 350 track is available in either mill or 25 micron clear anodised aluminium for improved corrosion performance. Fascia option is also available for a clean uninterrupted look. A comprehensive range of bottom channels and guides are available to suit a wide range of applications.

Max panel weight: 350kg

Max panel height: 3300mm

Min panel thickness: 35mm

Application: Interior and exterior sliding timber, metal or aluminium shutters and doors

Optional Accessories

Simultaneous: SIM/2 (Max panel weight 100kg)

Telescopic: TEL/2 (Max panel weight 120kg)
TEL/3 (Max panel weight 100kg)

Fascia: 353

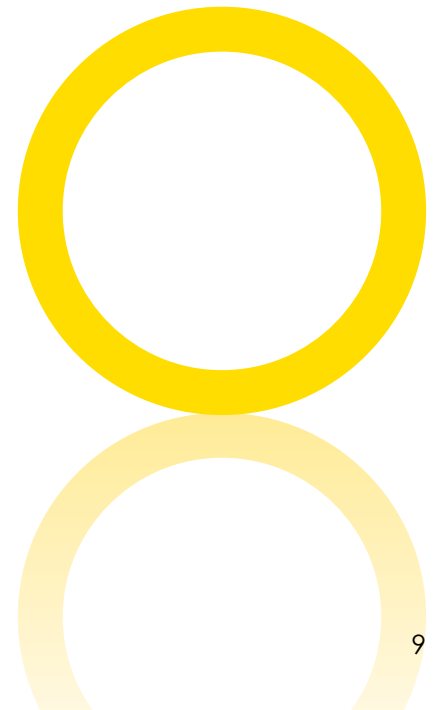

Single Run 80 and 100

For top hung straight sliding panels, max 80kg or 100kg each

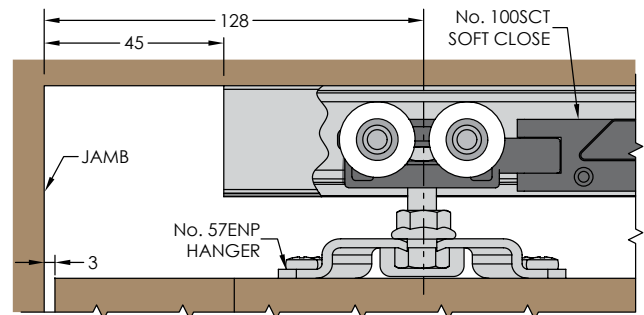
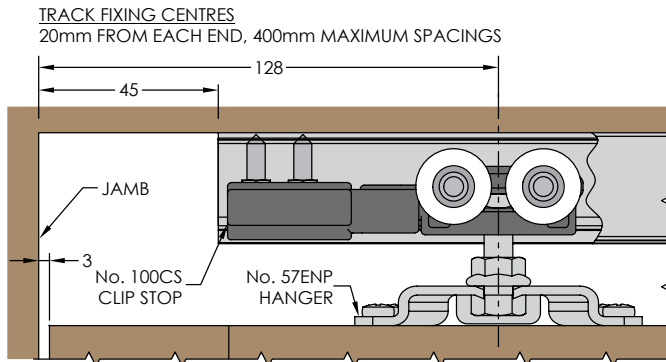

620 MIN PANEL WIDTH SINGLE SOFT CLOSE
970 MIN PANEL WIDTH FOR DOUBLE SOFT CLOSE

PANEL PREPARATION

No. 57ENP HANGER

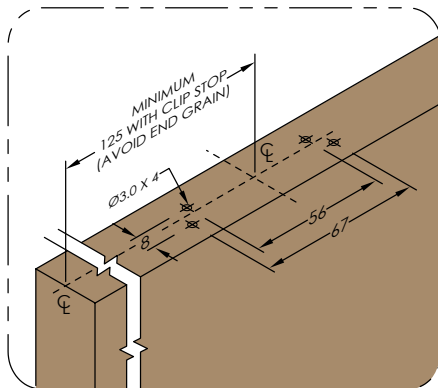

HANGER ASSEMBLY

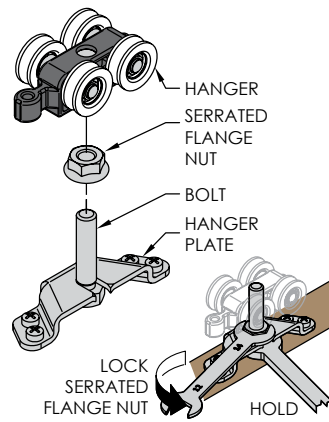

GUIDE OPTIONS

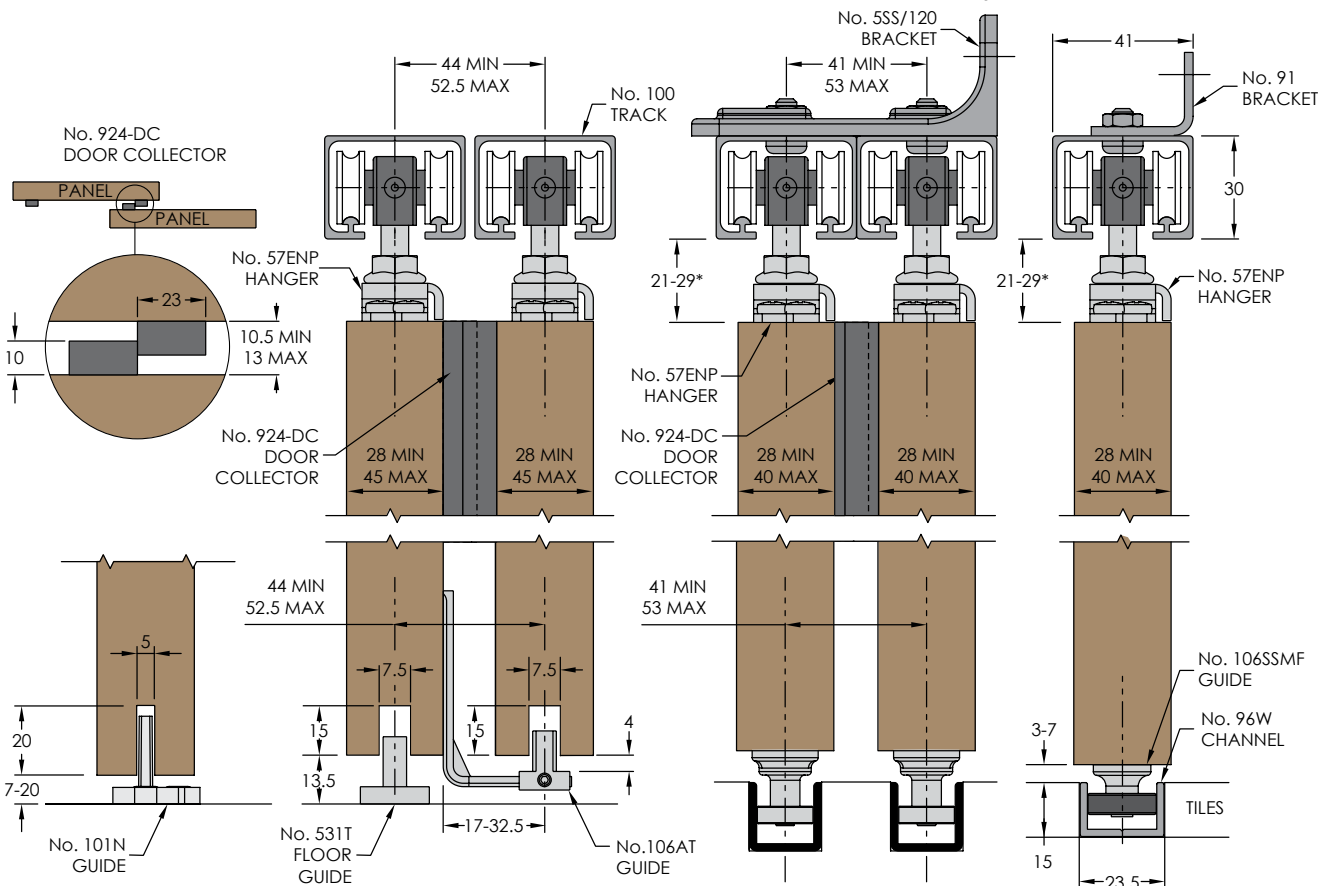
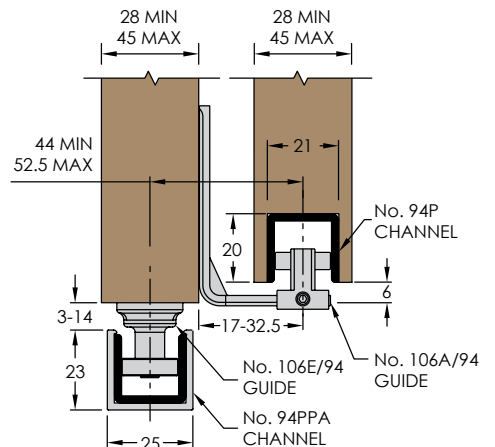

* WHEN USING No. 100SCT SOFT CLOSE, CLEARANCE 24-29

Single Run 120

For top hung straight sliding panels, max 120kg each

TRACK FIXING CENTRES

20mm FROM EACH END, 400mm MAXIMUM

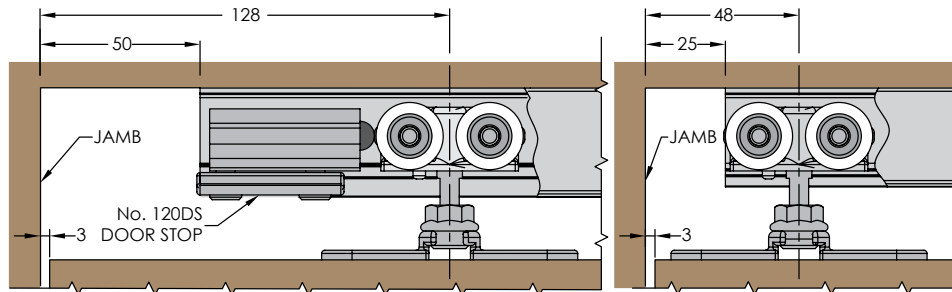

HANGER ASSEMBLY

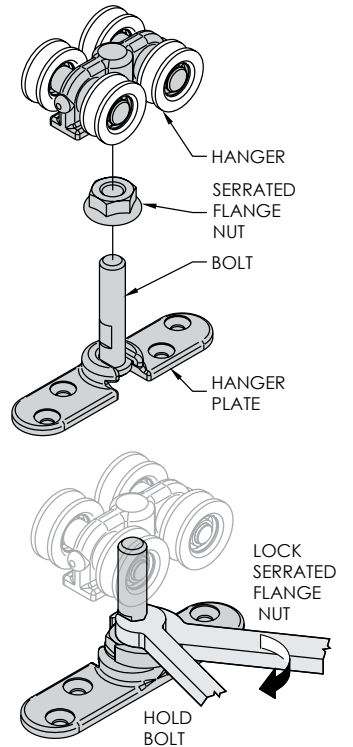

PANEL PREPARATION

No. 57EN HANGER

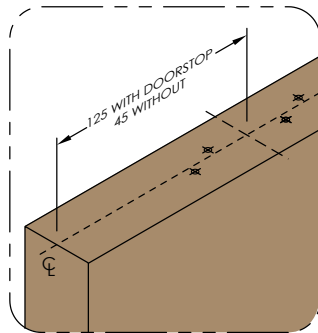

No. 50EN HANGER

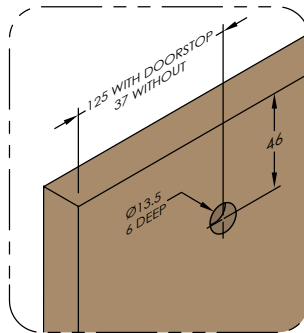

No. 58EN HANGER

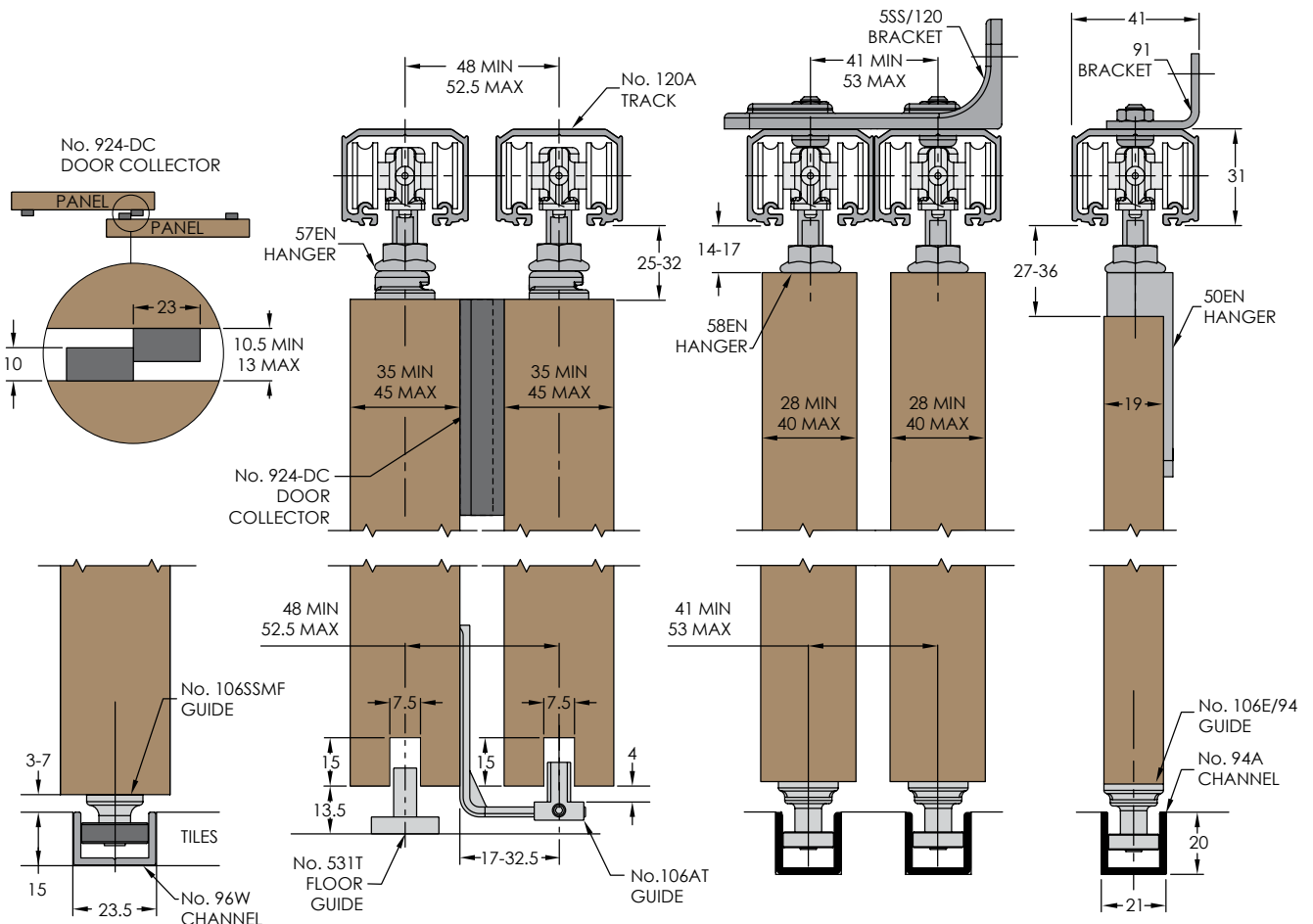
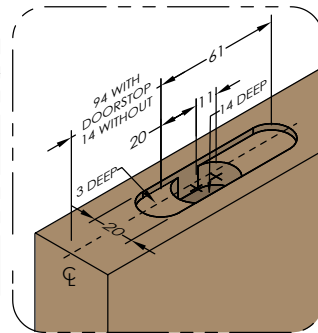

Single Run 180

For top hung straight sliding panels, max 180kg each

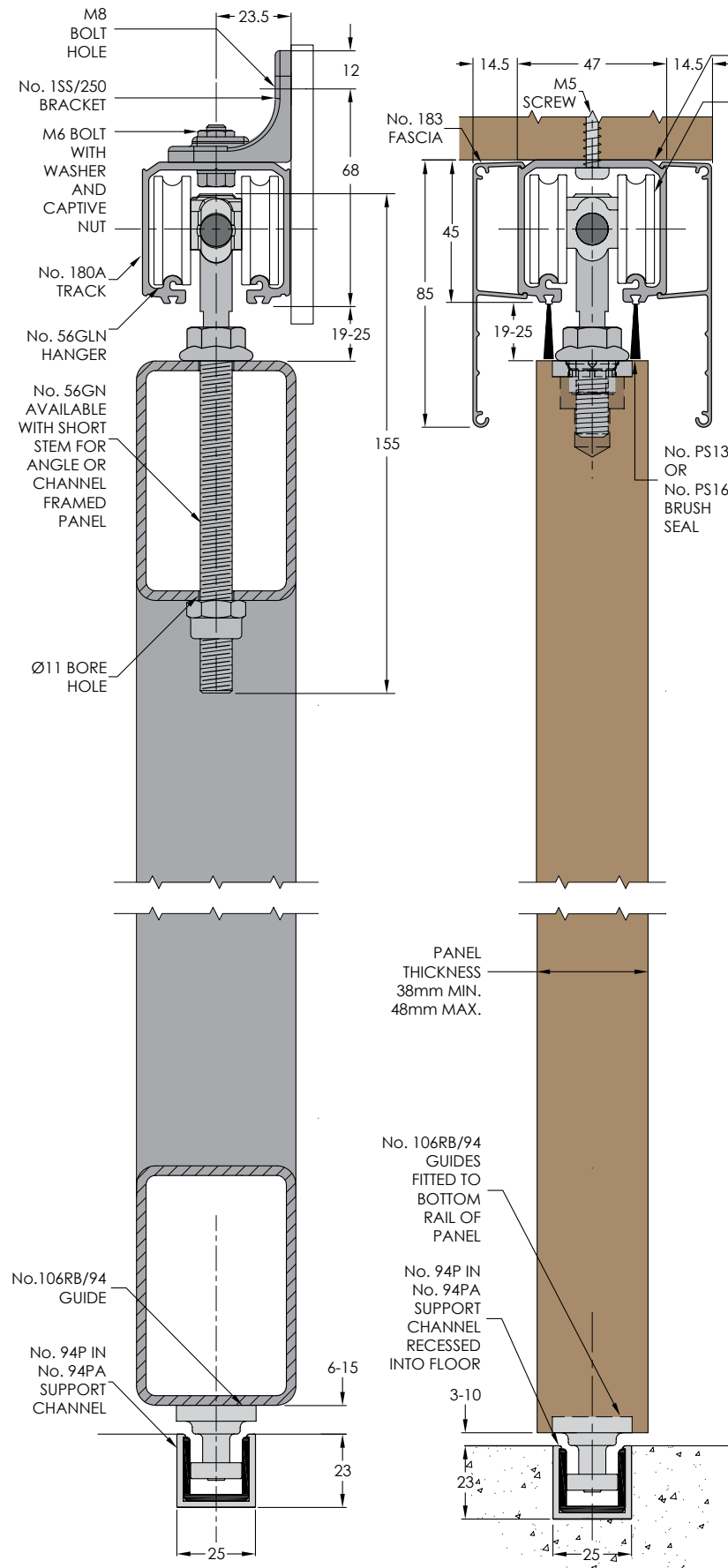

DOOR PREPARATION
No. 57GN HANGER

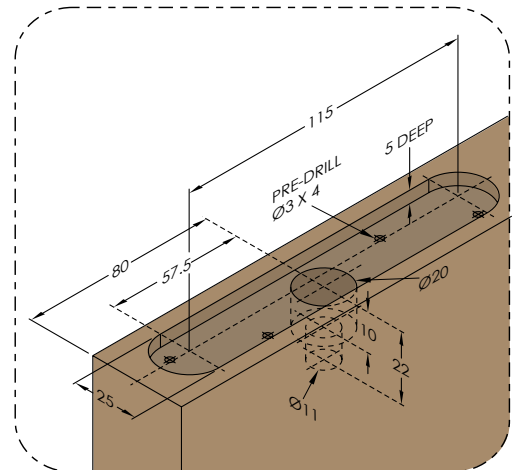

No. 52GN HANGER

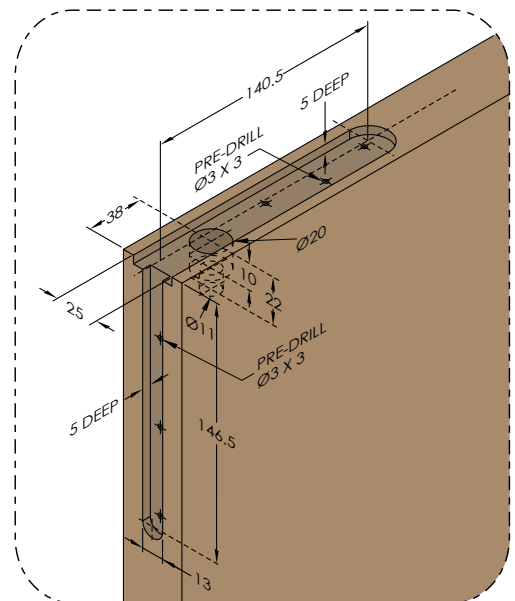

GUIDE SYSTEM
No. 106RB/94 GUIDE FITTED ON FLOOR IN OVERLAP AREA.
No. 94PPA CHANNEL RECESSED INTO PANEL

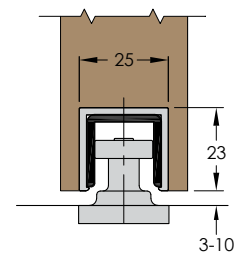

Single Run 350

For top hung straight sliding panels, max 350kg each

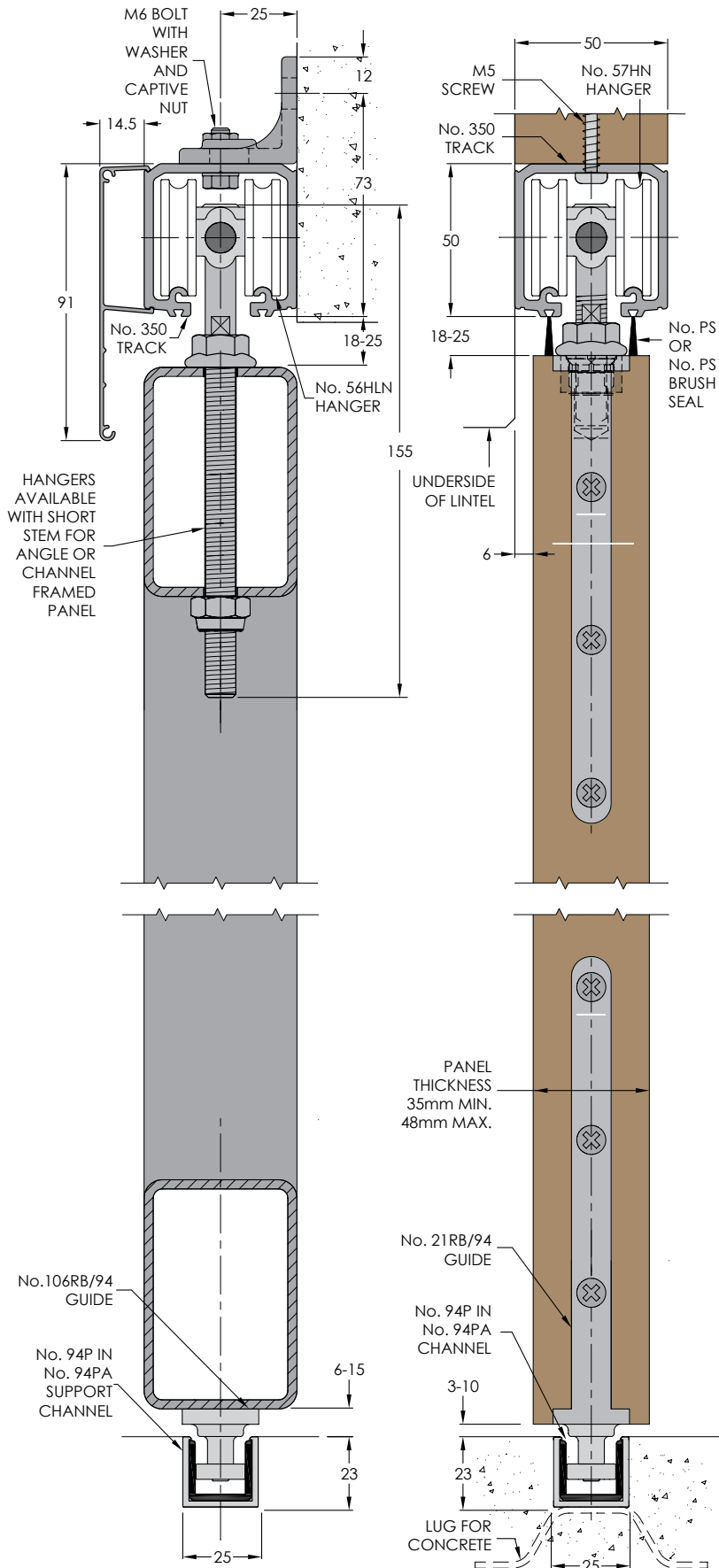

DOOR PREPARATION No. 52HN HANGER

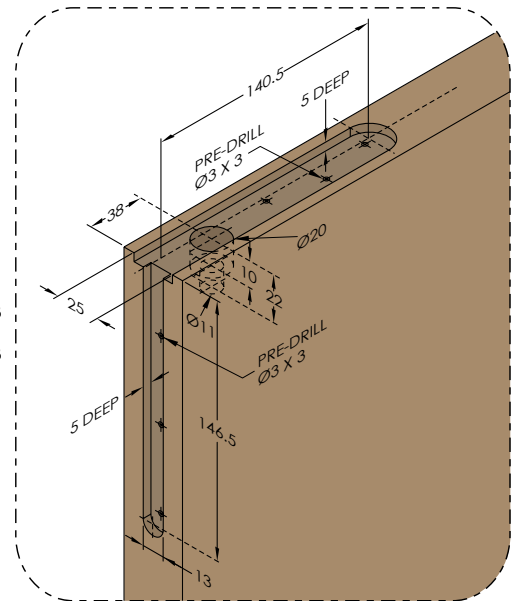

No. 57HN HANGER

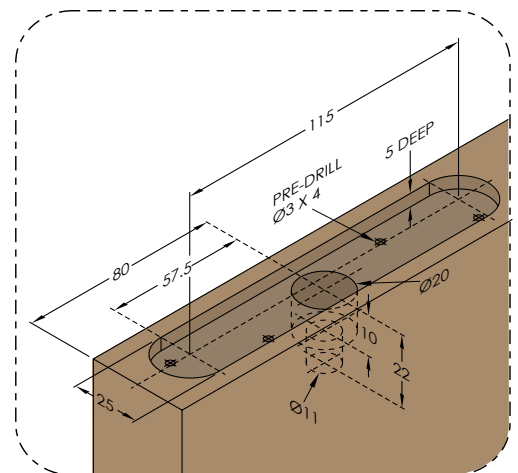

GUIDE SYSTEMS

No. 106RB/94 GUIDE FITTED ON FLOOR IN OVERLAP AREA.
No. 94PPA CHANNEL RECESSED INTO DOOR

No. 106RB/94 GUIDES FITTED TO BOTTOM RAIL OF DOOR. No. 94PPA CHANNEL RECESSED INTO FLOOR

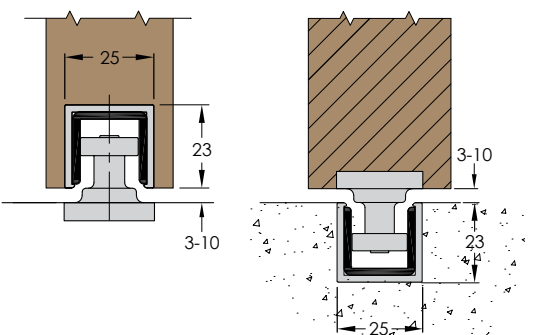

Hangers

Chrome precision bearing codes shown

Single Run 80
and 100

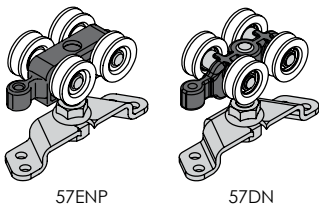
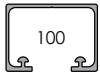

Single Run 120

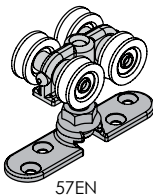

Single Run 180

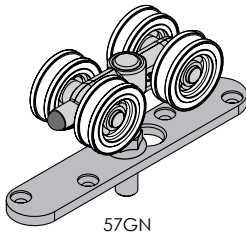
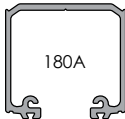

Single Run 350

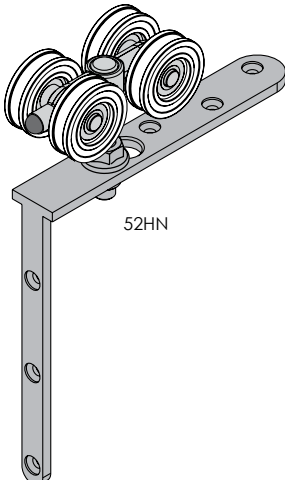
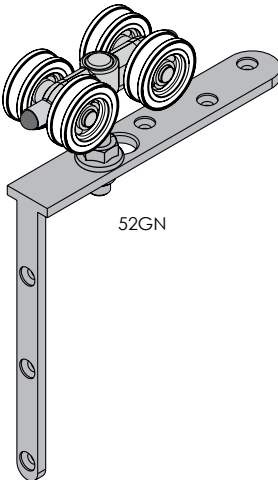
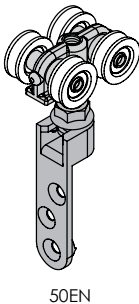
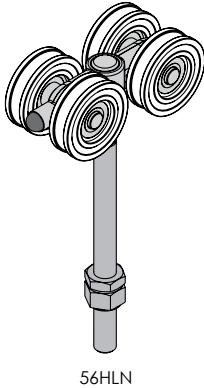
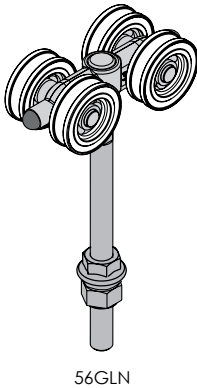
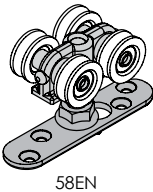
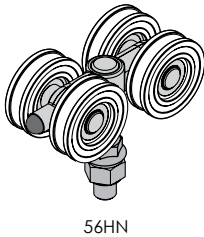
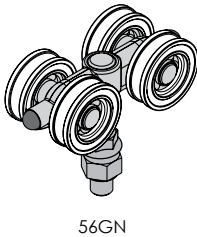
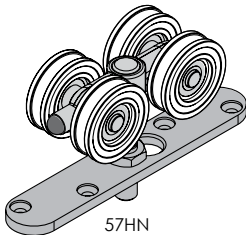
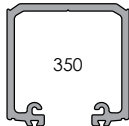

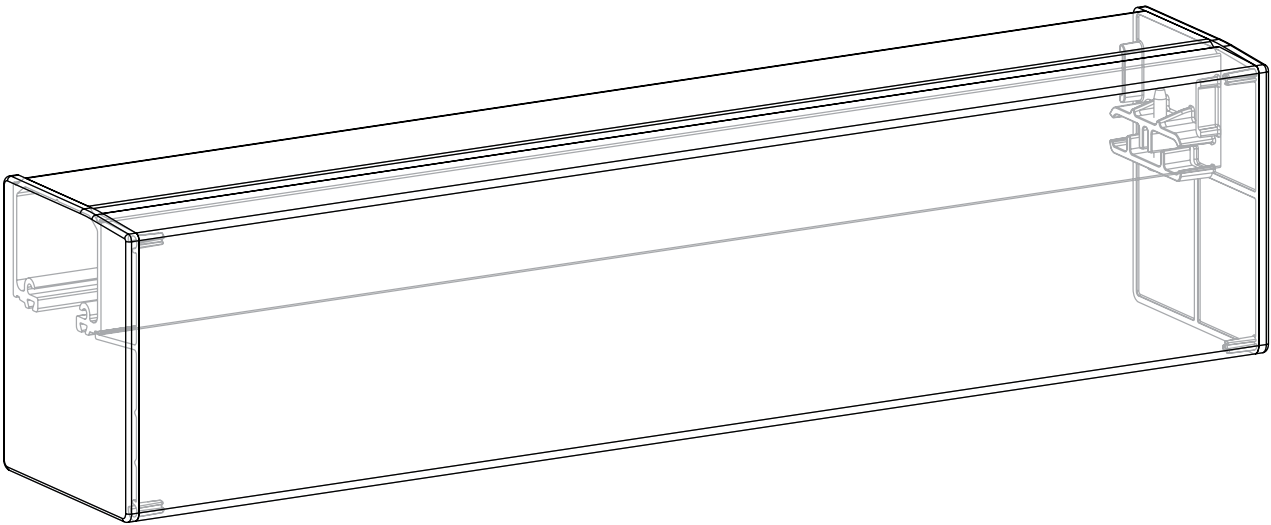
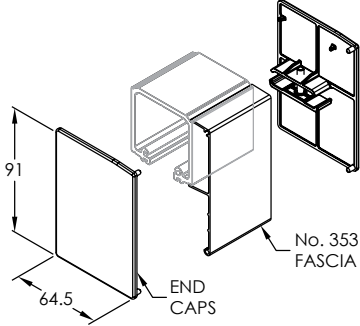
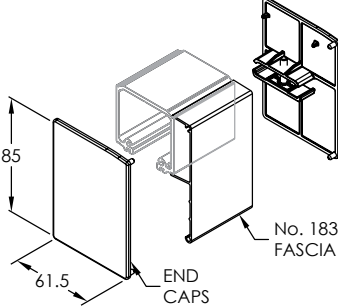
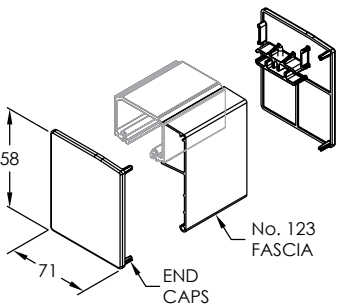
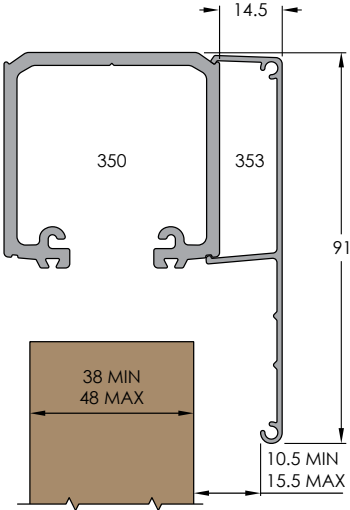
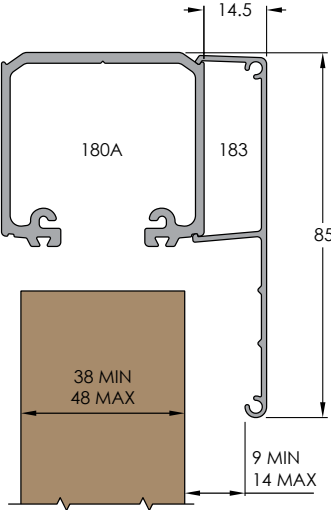
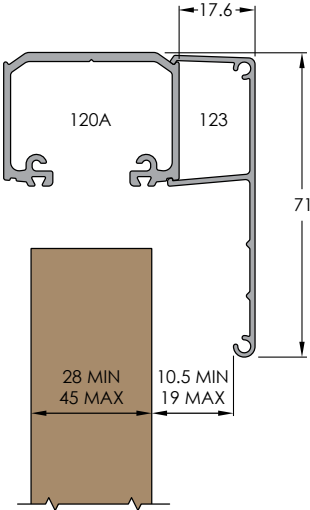

Soft Close

Single Run 80-100 accessory

The Soft Close is easy to install and simple to operate as the spring and damper work together to control the panel. The mechanism catches the moving door and reduces its speed before retracting it towards the jamb ensuring a quiet and soft stop every time. This reduction in speed also means little fingers are kept safe from slamming doors.

Note: Soft Close 100SCL and 100SCT available for Single Run 80 and 100 only.

Max panel weight 100SCL 10-50kg (10-25kg if used with SIM/2)

Max panel weight 100SCT 51-100kg (26-50kg if used with SIM/2)

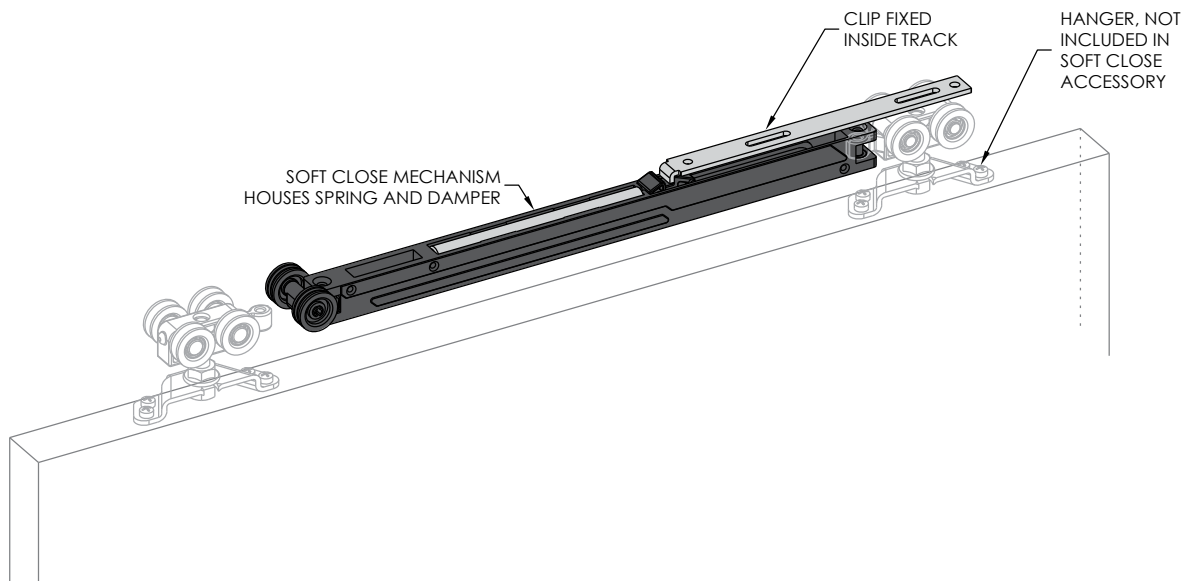

If a fascia and track option is required, use Soft Close with Single Run 80 and 100 hardware with 120A track and 123 Fascia.

Door Collector

These discreet nylon blocks with rubber inlays are easy to install on all of Brio's Single Run systems. They quietly pick up parallel panels and then release them in either the open or closed position.

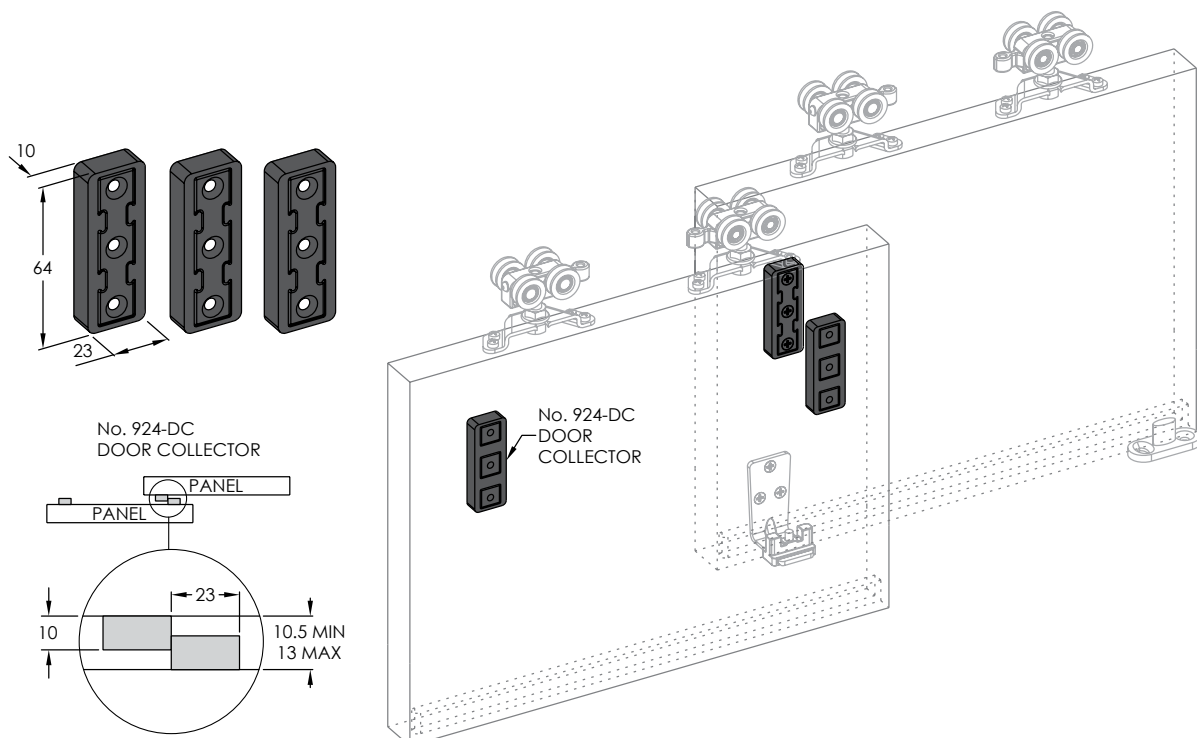

Simultaneous Kit

Single Run 100-350 accessory

Experience the freedom of opening up or closing off different areas of your layout in an instant with panels that can be used for privacy or simply hidden away by sliding them into wall pockets. This can be achieved with Brio's Simultaneous accessory for Single Run 100-350, which opens bi-parting panels symmetrically as one door will drive the other door in the opposite direction.

SIM/2 (Max panel weight 100kg)

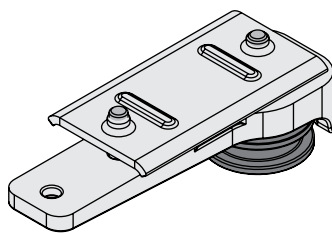
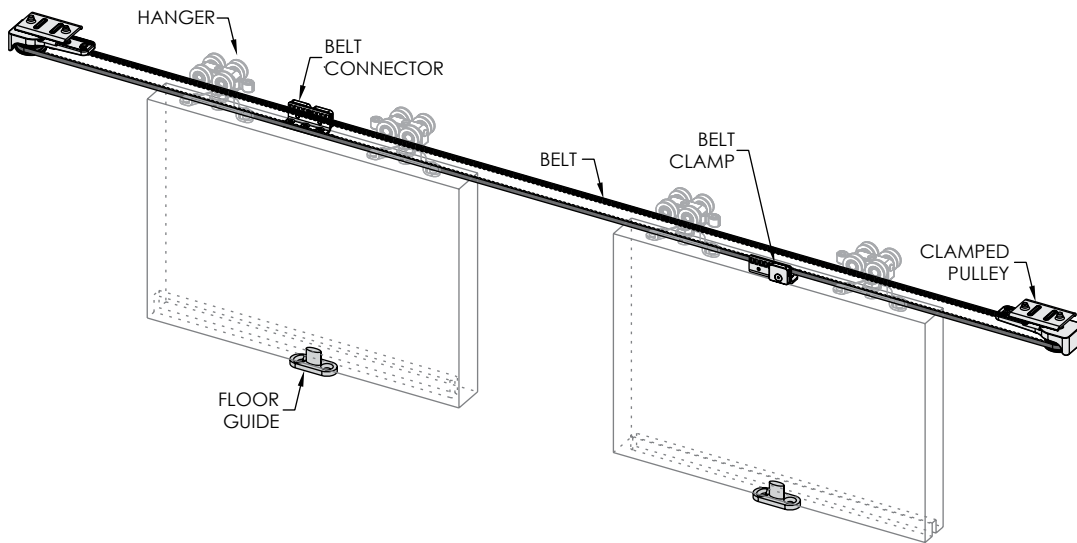

CLAMP PULLEY

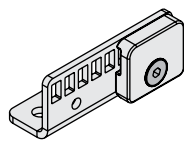

BELT CLAMP

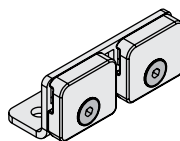

BELT CONNECTOR



BELT

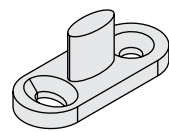

FLOOR GUIDE

Telescopic

Single Run 120-350 accessory

Enjoy quiet running, Telescopic doors with Brio's Single Run 120-350 accessory which operates bi-passing panels in 2 or 3 panel configurations. Operating one door will drive the other stacked panels to traverse across the opening.

TEL/2 (Max panel weight 120kg)

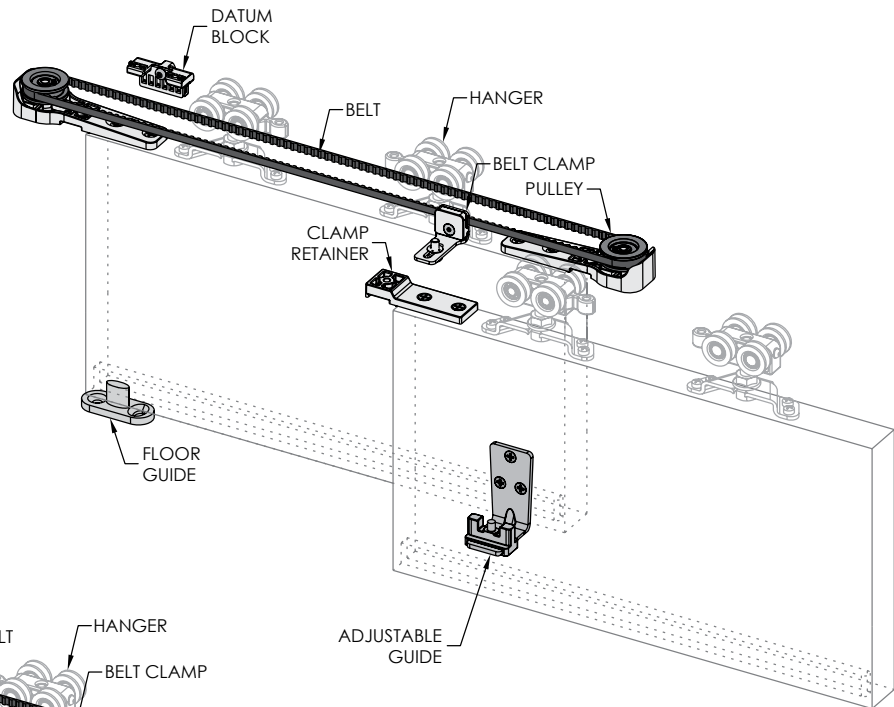

TEL/3 (Max panel weight 100kg)

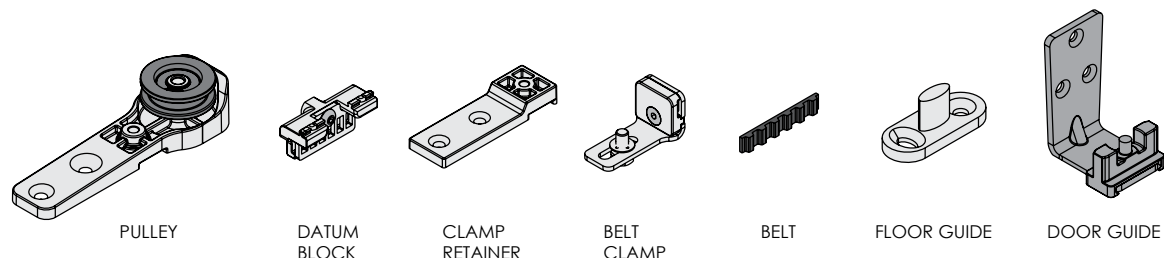
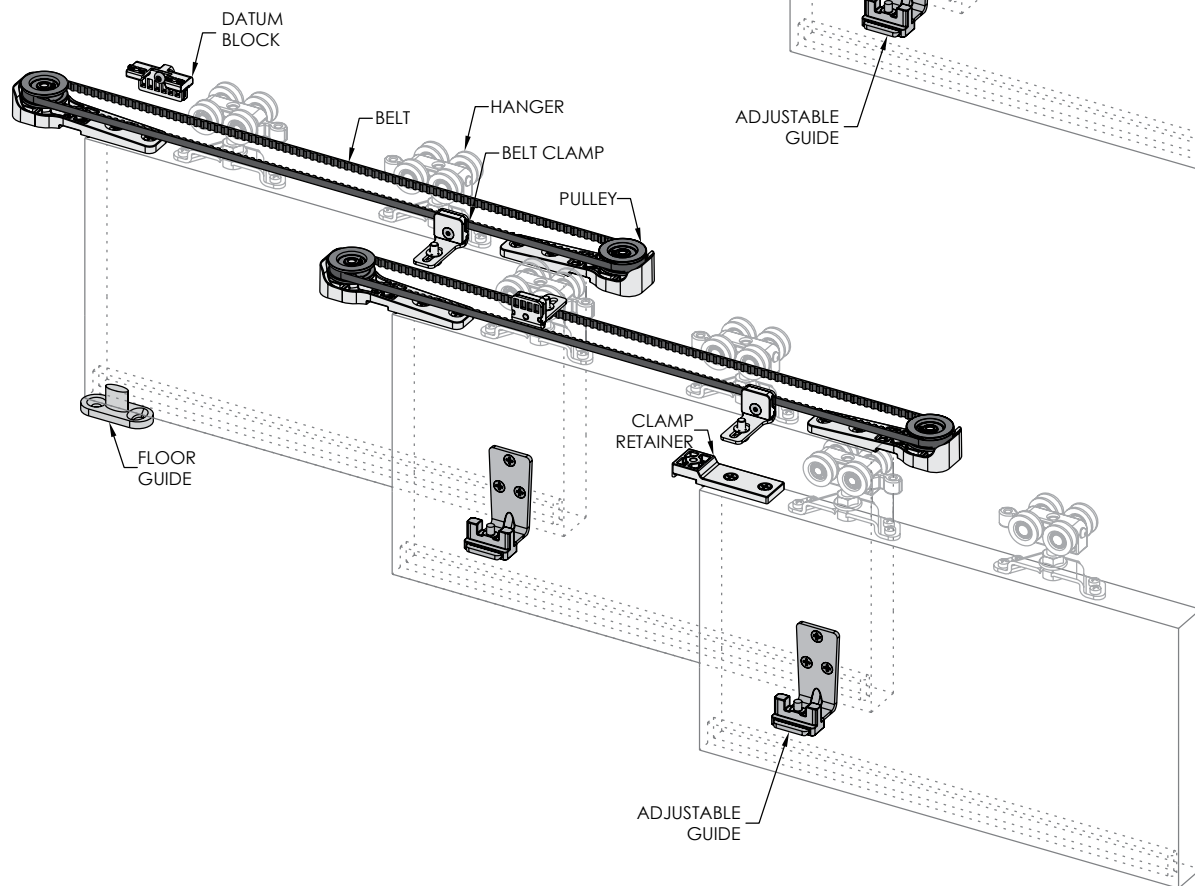

Specifications

Panel Specification	80 Series	100 Series	120 Series	180 Series	350 Series
Maximum Panel Weight	80kg	100kg	120kg	180kg	350kg
Maximum Panel Height	3000mm	3000mm	3000mm	3000mm	3300mm
Minimum Panel Thickness	28mm	28mm	19mm	35mm	35mm
Brackets					
Single Face Fix	91LS	91LS	1SS/250	1SS/250	1SS/250
Double Face Fix	-	-	5SS/120	5SS/250	5SS/250
Door Stop					
Clip Stop	100CS	100CS	-	-	-
Door Stop	-	-	120DS	180DS	180DS
Hangers Chrome Precision Bearing					
For Timber Panels - plate (flush)	58ENP	58ENP	58EN	-	-
For Timber Panels - plate (surface)	57ENP	57DN	57EN	57GN	57HN
For Timber Panels - angle fitting	-	-	-	52GN	52HN
For Metal Panels - plate fitting	-	-	-	57GN	57HN
For Metal Panels - angle frame	-	-	56EN	56GN	56HN
For Metal Panels - box frame	-	-	-	56GLN	56HLN
Hangers Stainless Steel Bearing					
For Timber Panels - plate (flush)	58ENP	58ENP	58SS/EN	-	-
For Timber Panels - plate (surface)	57SS/ENP	57SS/DN	57SS/EN	57SS/GN	57SS/HN
For Timber Panels - angle fitting	-	-	-	52SS/GN	52SS/HN
For Metal Panels - plate fitting	-	-	-	57SS/GN	57SS/HN
For Metal Panels - angle frame	-	-	56SS/EN	56SS/GN	56SS/HN
For Metal Panels - box frame	-	-	-	56SS/GLN	56SS/HLN
Track					
Aluminium Track	100	100	120A & 120R	180A	350
Clear Anodising	25µm	25µm	25µm & 25µm	25µm	25µm
Standard Lengths	2000mm, 3000mm, 4000mm and 6000mm				
Guide					
For Timber Panels - SS plate	106E/94	106E/94	106E/94	106RB/94	106RB/94
For Timber Panels - SS plate tyred bearing	106SSMF	106SSMF	106SSMF	-	-
For Timber Panels - nylon guide	101N	101N	101N	-	-
For Timber Panels - spring loaded guide	108N/814	108N/814	108N/814	-	-
For Timber Panels - angle fitting	-	-	-	21RB/94	21RB/94
For Metal Panels - angle frame	-	-	106E/94	106RB/94	106RB/94
For Metal Panels - box frame	-	-	-	106RB/94	106RB/94
Multiple Panels - bearing	106A/94	106A/94	106A/94	106A/94	106A/94
Multiple Panels - T slot	106AT	106AT	106AT	106AT	106AT
Channel					
Aluminium Track	94A	94A	94A	94A	94A
Brass	94B	94B	94B	94B	94B
Polypropylene	94P	94P	94P	94P	94P
Aluminium and Polypropylene	94PPA	94PPA	94PPA	94PPA	94PPA
Aluminium Track (106SSMF)	96W	96W	96W	96W	96W
Standard Lengths	2000mm, 3000mm, 4000mm and 6000mm				
Accessories					
Interlock 4.8m, Weatherseal*	924-CA48	924-CA48	924-CA48	924-CA48	924-CA48
Door Collector - multiple panels	924-DC	924-DC	924-DC	924-DC	924-DC
Soft Close (10-50kg)	100SCL	100SCL	-	-	-
Soft Close (51-100ka)	100SCT	100SCT	-	-	-

*Interlock available in clear, black and bronze anodise

About Allegion™

Allegion (NYSE: ALLE) is a global pioneer in seamless access, with leading brands like CISA®, Interflex®, LCN®, Schlage®, SimonsVoss® and Von Duprin®. Focusing on security around the door and adjacent areas, Allegion secures people and assets with a range of solutions for homes, businesses, schools and institutions. Allegion had US\$2.7 billion in revenue in 2018, and sells products in almost 130 countries.

For more, visit www.allegion.com.au or www.allegion.co.nz

Brio ■  ■  ■  ■ 

Allegion (Australia) Pty Ltd
Freephone 1800 098 094
Email auinfo@allegion.com
www.allegion.com.au

Allegion (New Zealand) Limited
Freephone 0800 477 869
Email nzinfo@allegion.com
www.allegion.co.nz

