



Kilargo IS5121si Sweep Action Seal 25mm - Clear Anodised Aluminium

LO-IS5121SI

PRODUCT OPTIONS

Door Seal Length: 1000mm
2250mm



DESCRIPTION

These silicone sweep seals are designed to be used around the head and jambs, door bottom and meeting stiles of single or double swing doors, revolving, tilt-up and roller doors. These seals help protect against ambient and medium temperature smoke, draught and dust, and weather penetration. The slim line carriers are aesthetically angled to avoid dust build-up. These seals provide excellent sealing solutions for pivot action smoke doors and clean room applications.

Gap Size

Min. 19mm / max. 24mm

Standard Lengths

1000mm

2250mm

Also available in: 250mm increments from 1000mm to 3000mm

Standard Finishes

Silver anodised aluminium carrier with grey silicone fin

Fixing

Silicone sweep seals (within carriers) can be screw-fixed or self-adhered to the desired surface

Fixing screws and aggressive backing tape are supplied

Approvals

Fire tested to AS1530 Part 4 in accordance with AS1905 Part 1

Conforms with NCC Specification C3.4 smoke sealing requirements

Acoustically tested in accordance with AS1191, ISO140.3 & ISO10140-2

SPECIFICATION

MPN	IS5121SI
Brand	Kilargo
Product Height	48mm
Product Thickness	6mm
Product Finish or Colour	Clear Anodised (CA)
Product Material	Aluminium



Kilargo IS5121si Sweep Action Seal 25mm - Clear Anodised Aluminium

Scan to view online and for additional product information , or call us on **1800 555 600**.

Print Date: 20/4/24

Includes Fixing Screws	Yes
Fire Tested	Yes
Acoustic Rated to AS1191 and ISO140.3	Yes
Suitable for Smoke Doors	Yes
Suitable for Door Type	Timber Doors, Aluminium Doors
Contains Intumescent Material	No
Seal Can Be Installed	Surface Fix
Brush / Gasket Length	25mm
Gasket / Seal Colour	Grey
Gasket Material	Silicon Impregnated
Min Door Gap	19mm
Max Door Gap	24mm
Self Adhesive	Yes
Product Warranty	2 Years

ADDITIONAL IMAGES

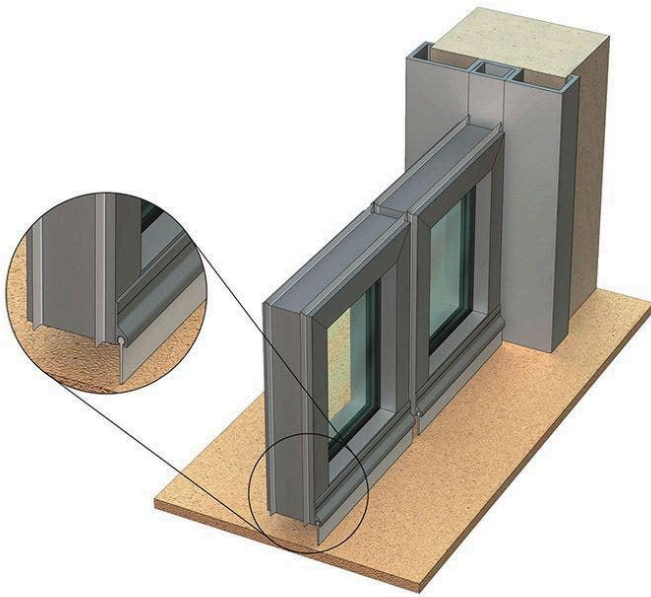

Kilargo IS5121si Sweep Action Seal 25mm - Clear Anodised Aluminium
Scan to view online and for additional product information , or call us on **1800 555 600**.

Print Date: 20/4/24