



Sabre Narrow Plate External Cylinder & Lever Plate - Satin Stainless Steel

SKU SAB-NSS-CCL-H01-SS

MPN SAB-NSS-CCL-H01-SS



DESCRIPTION

Sabre Narrow Plate External Cylinder & Lever Plate Satin Stainless Steel

Dimensions - 185mm L x 26mm W x 12mm D
Suits 35mm - 50mm aluminium doors
Tested for durability up to 300,000 cycles
Non-handed lever
Suits popular Australian short backset mortice locks
AS1428.1 compliant
2 x 65mm M4 fixing screws included

Finish

Satin satinless steel

Warranty

10 year mechanical warranty
5 year finish warranty

SPECIFICATION

MPN	SAB-NSS-CCL-H01-SS
Brand	Sabre
Projection or Length	58.5mm
Plate Height	185mm
Plate Width	26mm
Product Finish or Colour	Satin Stainless Steel (SSS)
Product Material	304 Stainless Steel
Square / Round Face	Square
Includes Fixing Screws	Yes
AS1428.1 Compliant	Yes
Fire Tested	No
Suitable for Door Type	Aluminium Doors
SCEC Rating	No
Handing	Non-Handed



Sabre Narrow Plate External Cylinder & Lever Plate - Satin Stainless Steel
Scan to view online and for additional product information , or call us on **1800 555 600**.

Print Date: 29/4/24

Cylinder Cut Out Profile	Oval
Spindle Size	7.6mm
Fixing	Concealed Fixed
Finger Clearance	43mm
Max Door Thickness	50mm
Product Warranty	10 Years Mechanical

ADDITIONAL IMAGES

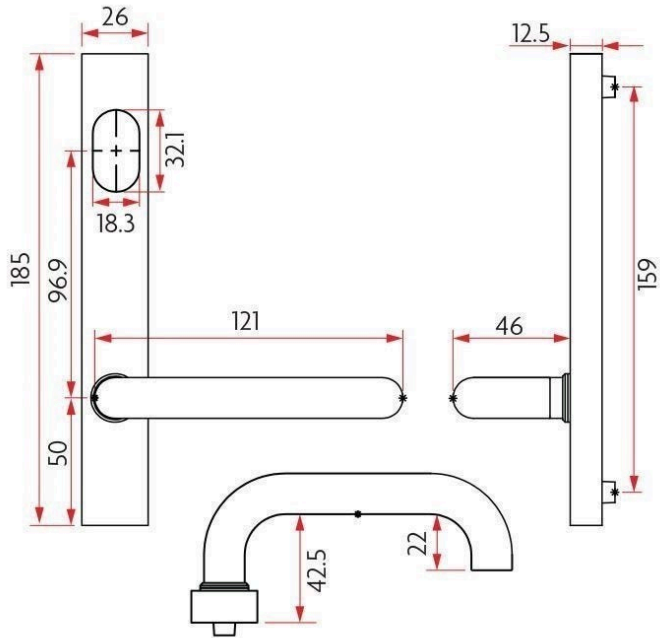

Sabre Narrow Plate External Cylinder & Lever Plate - Satin Stainless Steel
 Scan to view online and for additional product information , or call us on **1800 555 600**.

Print Date: 29/4/24