



Sabre Narrow Plate Internal Visible Accessible Turn & Lever Plate - Satin Stainless Steel - Left Handed

SKU SAB-NSS-VAL-H01-L-SS

MPN SAB-NSS-VAL-H01-L-SS



DESCRIPTION

Sabre Narrow Plate Internal Visible Accessible Turn & Lever Plate LH Satin Stainless Steel

Dimensions - 185mm L x 26mm W x 12mm D
 Suits 35mm - 50mm aluminium doors
 Tested to 300,000 cycles
 Satin stainless steel finish
 Suits popular Australian short backset mortice locks
 10 year manufacturer's warranty
 AS1428.1 compliant

SPECIFICATION

MPN	SAB-NSS-VAL-H01-L-SS
Brand	Sabre
Projection or Length	58.5mm
Plate Height	185mm
Plate Width	26mm
Product Finish or Colour	Satin Stainless Steel (SSS)
Product Material	304 Stainless Steel
Square / Round Face	Square
Includes Fixing Screws	No
AS1428.1 Compliant	Yes
Fire Tested	No
Suitable for Door Type	Aluminium Doors
SCEC Rating	No
Handing	Left Hand, Right Hand Lock
Spindle Size	7.6mm
Fixing	Visible Fixed
Finger Clearance	43mm
Max Door Thickness	50mm
Product Warranty	10 Years Mechanical

ADDITIONAL IMAGES



Sabre Narrow Plate Internal Visible Accessible Turn & Lever Plate - Satin Stainless Steel - Left Handed

Scan to view online and for additional product information , or call us on **1800 555 600**.

Print Date: 25/4/24

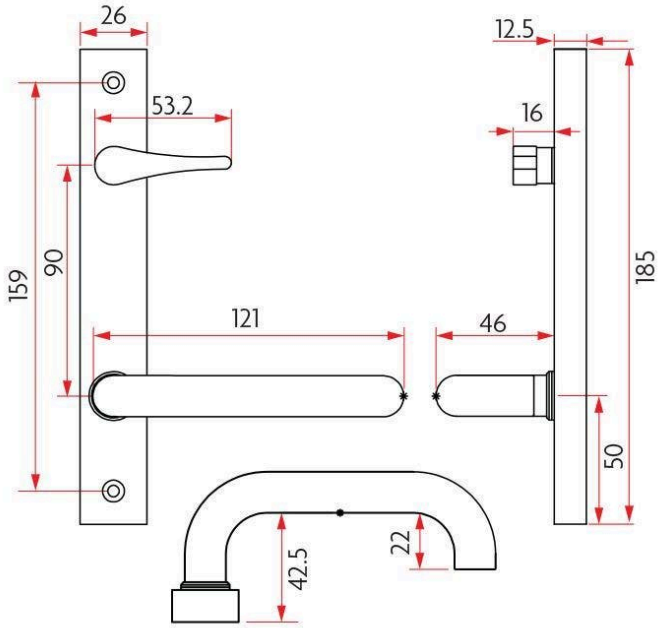

Sabre Narrow Plate Internal Visible Accessible Turn & Lever Plate - Satin Stainless Steel - Left Handed
Scan to view online and for additional product information , or call us on **1800 555 600**.

Print Date: 25/4/24