

Since 1982

TRADCO

Defining the Details

Tradco 1650 Sash Window Lift - Satin Chrome - Small

SKU THA-1650

MPN1650

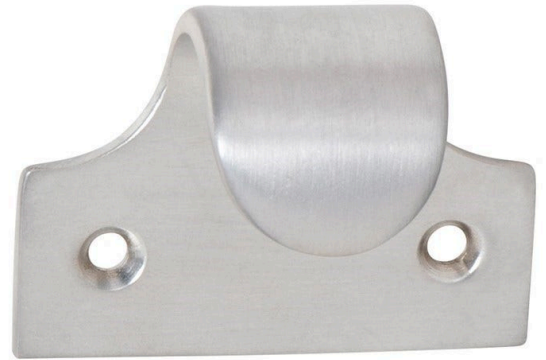

DESCRIPTION

Tradco 1650 Sash Lift Small SC

Material

Solid brass

Suitability

Suits internal residential applications

Finish

Satin Chrome

Features

Height 34mm x Width 42mm x Projection 25mm

SPECIFICATION

| | |
|---------------------------------|-------------------|
| MPN | 1650 |
| Brand | TradCo |
| Product Width | 42mm |
| Product Height | 34mm |
| Product Depth | 25mm |
| Product Finish or Colour | Satin Chrome (SC) |
| Product Material | Brass |
| Includes Fixing Screws | Yes |
| Fixing | Visible Fixed |
| Product Warranty | 1 Year Mechanical |



Tradco 1650 Sash Window Lift - Satin Chrome - Small

Scan to view online and for additional product information , or call us on **1800 555 600**.

Print Date: 24/4/24