



# Metlam Moda Toilet Partition Spring Hinge - Right Hand - Antimicrobial

**SKU** MLMODAHINGE-RH-ANMB

**MPN** MODA\_RHHINGE\_ANMB



## DESCRIPTION

### Metlam Antimicrobial Moda Spring Hinge - RH - ANMB

#### Material

Diecast Zinc, Alloy ZP3  
Brass shaft  
Nylon inserts, ABS Snap on covers

#### Finish

Antimicrobial coating

#### Antimicrobial Features

Antimicrobial describes something that can resist and prevent the growth of microbes including bacteria, fungi and mould. Antimicrobial protection significantly reduces the levels of microbes on a protected surface by up to 99.99%. The in-built antimicrobial protection means the bacteria cannot survive. Once added to a product the antimicrobial technology starts to work immediately, tests have shown that up to 80% of microbial contamination will be killed within just 15 minutes and over 99% in 2 hours.

#### Mounting/Specify

Concealed screw fix  
Right handed

#### Features

Spring assisted door opening/ door closing  
Fully adjustable spring to suit door - no tension to full tension spring  
Reversible hold open / hold closed  
Lift off capability

#### Load Rating:

15kg per hinge  
For optimum performance - 2 hinges per door up to 30kgs, for doors over 30kg allow for 15kg per hinge

## SPECIFICATION

**MPN**

MODA\_RHHINGE\_ANMB



**Metlam Moda Toilet Partition Spring Hinge - Right Hand - Antimicrobial**

Scan to view online and for additional product information , or call us on **1800 555 600**.

Print Date: 25/4/24

<b>Brand</b>	Metlam
<b>Product Height</b>	76.6mm
<b>Product Width</b>	85.5mm
<b>Fixing Method</b>	Screw Fixing
<b>Product Finish or Colour</b>	Antimicrobial
<b>Product Material</b>	Zinc Diecast
<b>Max Door Weight</b>	15kg
<b>Includes Fixing Screws</b>	No
<b>Fixing</b>	Concealed Fixed
<b>Handing</b>	Right Hand
<b>Product Warranty</b>	1 Year

## ADDITIONAL IMAGES

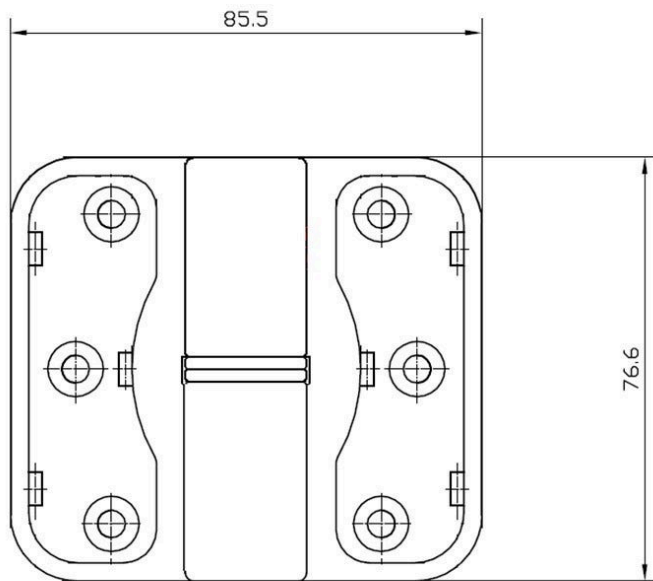

**Metlam Moda Toilet Partition Spring Hinge - Right Hand - Antimicrobial**  
Scan to view online and for additional product information , or call us on **1800 555 600**.

Print Date: 25/4/24